

**MODEL HPQT3  
HIGH PRESSURE EXTERNALLY PRESSURIZED  
EXPANSION COMPENSATOR  
FOR RISER APPLICATION**

**DESIGN DATA**

CONFORMS TO MIL-DTL-17813H  
 MAXIMUM WORKING TEMPERATURE: 500°F (260°C)\*  
 MAXIMUM WORKING PRESSURE: 175 PSI (1,206 kPa (g))\*  
 MAXIMUM TEST PRESSURE: 250 PSI (1,809 kPa) @ 70°F  
 AXIAL COMPRESSION: 3" (80mm)  
 AXIAL EXTENSION: 1/2" (13mm)

HOUSING CUT AWAY TO SHOW BELLOWS

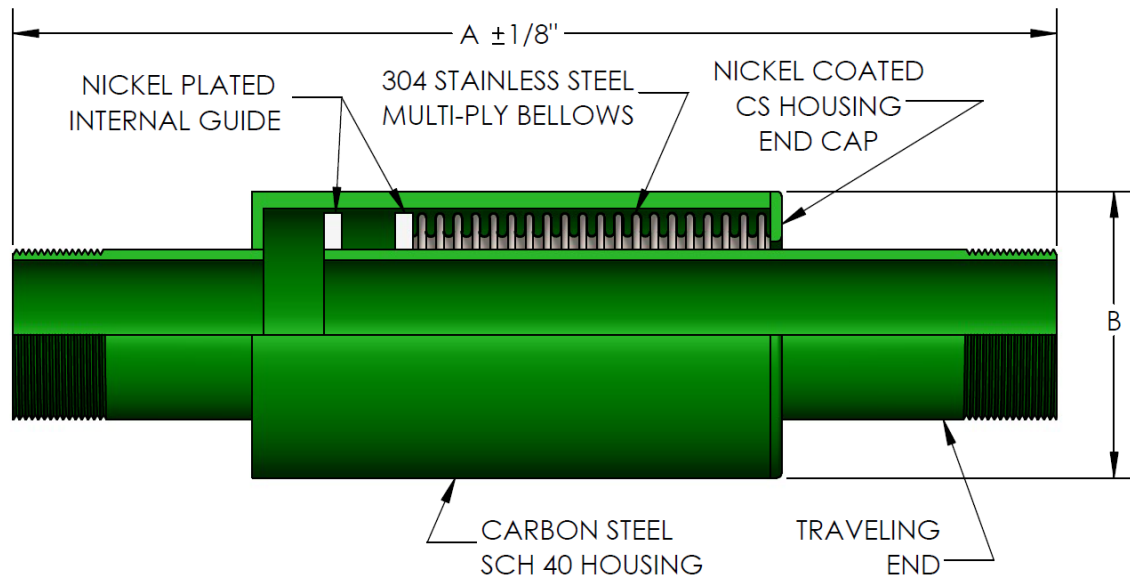
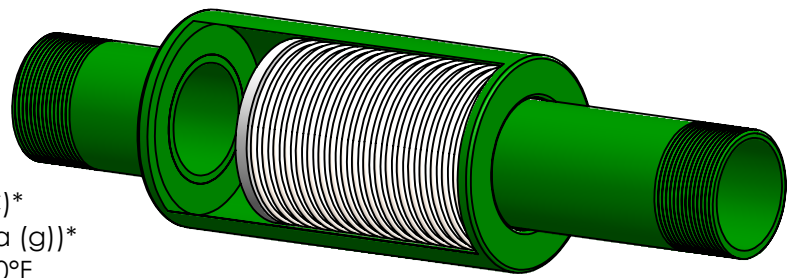

THIS EXPANSION JOINT IS DESIGNED FOR USE IN RISER APPLICATION AND AXIAL MOVEMENT ONLY. CONSULT METRAFLEX FOR GUIDING AND ANCHORING OF PIPE IN RISER APPLICATION. FOR HORIZONTAL RUNS, THE GUIDING AND ANCHORING RECOMMENDATION OF THE EXPANSION JOINT MANUFACTURERS ASSOCIATION IS TO BE FOLLOWED.

QTY	PART NUMBER	PIPE SIZE		A	B	EFFECTIVE AREA (in <sup>2</sup> )	SPRING RATE (lb/in)	WEIGHT	PROJECT INFORMATION
		INCH	MM						
	HPQT30075	3/4"	20	22"	2-3/8"	1.5	58	9	
	HPQT30100	1"	25	22"	2-1/2"	2.1	63	12	
	HPQT30125	1-1/4"	32	22"	3"	3.3	52	13	
	HPQT30150	1-1/2"	38	23"	3-1/2"	4.3	82	15	
	HPQT30200	2"	50	23"	4"	6.3	117	20	
	HPQT30250	2-1/2"	65	24-1/2"	5"	8.8	132	31	
	HPQT30300	3"	80	25-3/8"	5-1/2"	13.1	161	36	
	HPQT30400	4"	100	25-3/8"	6-5/8"	20.8	341	49	

REV. 1	ADDED 4"
2323 W. HUBBARD ST. CHICAGO, IL 60612 TEL: 312-738-3800 FAX: 312-738-0415 WWW.METRAFLEX.COM	
<b>MODEL HPTQ3</b> HIGH PRESSURE EXPANSION COMPENSATOR	
DRAWN BY: <b>DEVINR</b>	DATE: <b>09/06/2024</b>
APPROVED:	DATE:
SCALE: <b>N/A</b>	DRAWING NUMBER: <b>HPQT3-1</b>

CUSTOMER: \_\_\_\_\_

PROJECT: \_\_\_\_\_

ENGINEER: \_\_\_\_\_